

Activity Detail

Final Day Sample Meeting - Aug 7, 2017

- Registration: 8:00am-9:00am
- General Session: 9:00am-9:45am
- Coffee Break: 9:45-10:00am
- Sale Manager Breakout: 10:15am-11:30am
- Associates Breakout: 10:15am-11:30am
- Coffee Break: 11:30am-12:noon

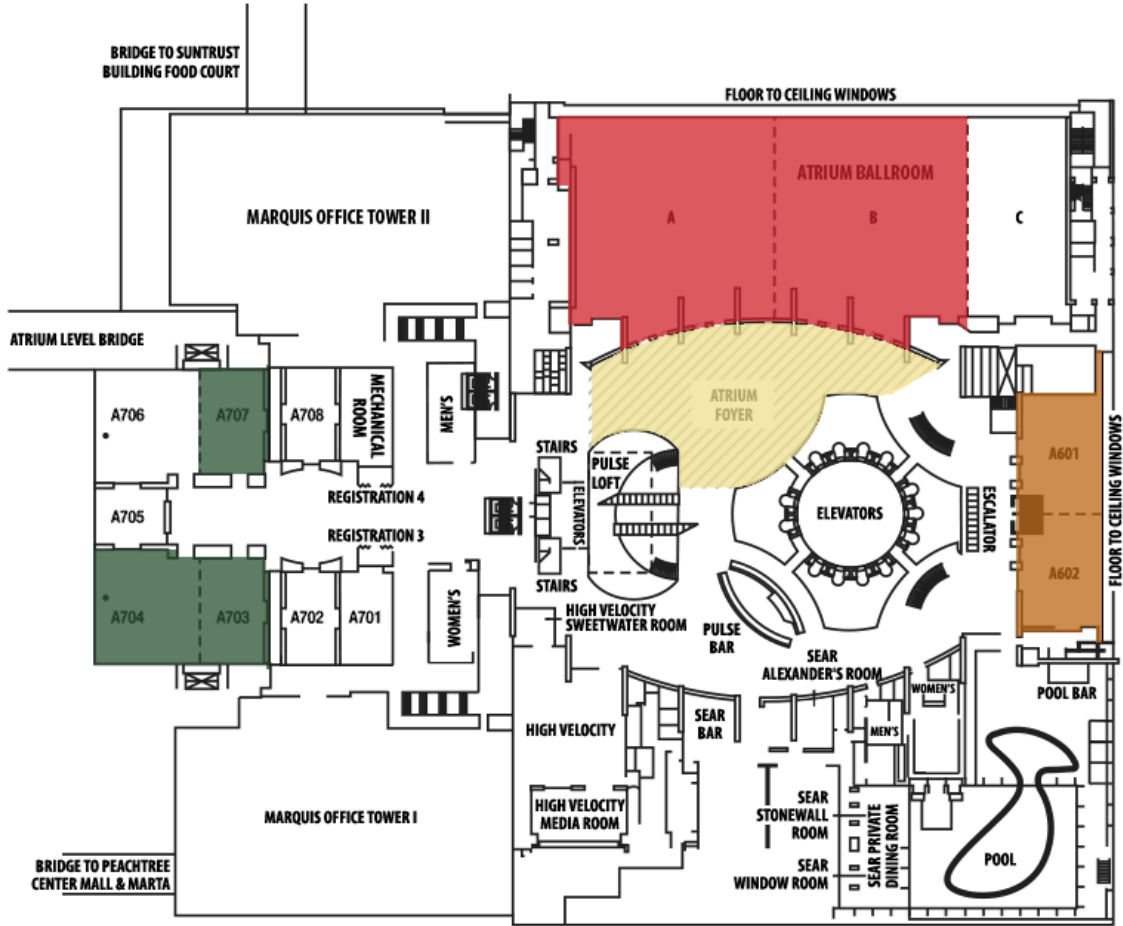

Activity Detail

Final Day Sample Meeting - Aug 7, 2017

Meeting Room	Dimensions (LxWxH)	Square Feet	Capacity				
			Theatre	Schoolroom	Hollow Square	Reception	Banquet
Atrium Ballroom	238x110x30	25,005	2,500	1,600	—	2,500	2,000
Atrium Ballroom A	110x105x30	11,170	1,110	720	—	1,100	880
Atrium Ballroom B	110x110x30	11,385	1,110	720	—	1,100	880
Atrium Ballroom C	23x110x30	2,450	240	140	—	225	180
A601	45x54x10	2,416	240	156	—	250	190
A602	45x54x10	2,419	240	156	—	250	190
A601 & A602	45x108x10	4,835	480	310	—	500	380
A701	25x45x10	1,140	110	70	50	120	70
A702	24x40x10	964	95	62	42	100	60
A703	31x51x10	1,599	150	100	—	160	120
A704	52x51x10	2,676	260	170	—	280	200
A703 & A704	83x52x10	4,275	420	270	—	450	320
A705	36x34x10	1,224	120	78	54	130	90
A706	52x51x10	2,676	260	170	—	250	200
A707	31x51x10	1,603	160	100	—	180	120
A706 & A707	83x52x10	4,279	420	270	—	450	320
A708	24x45x10	1,096	105	68	48	120	80

Activity Detail

Final Day Sample Meeting - Aug 7, 2017

- Group A - Team Building lead by leaders from the Midwest
- Group B - Team Building lead by leaders from the Southeast

- Group C - Team Building lead by leaders from the Northeast

All Team building exercises will begin at 1:00pm and will need to be finished by 3:00pm.

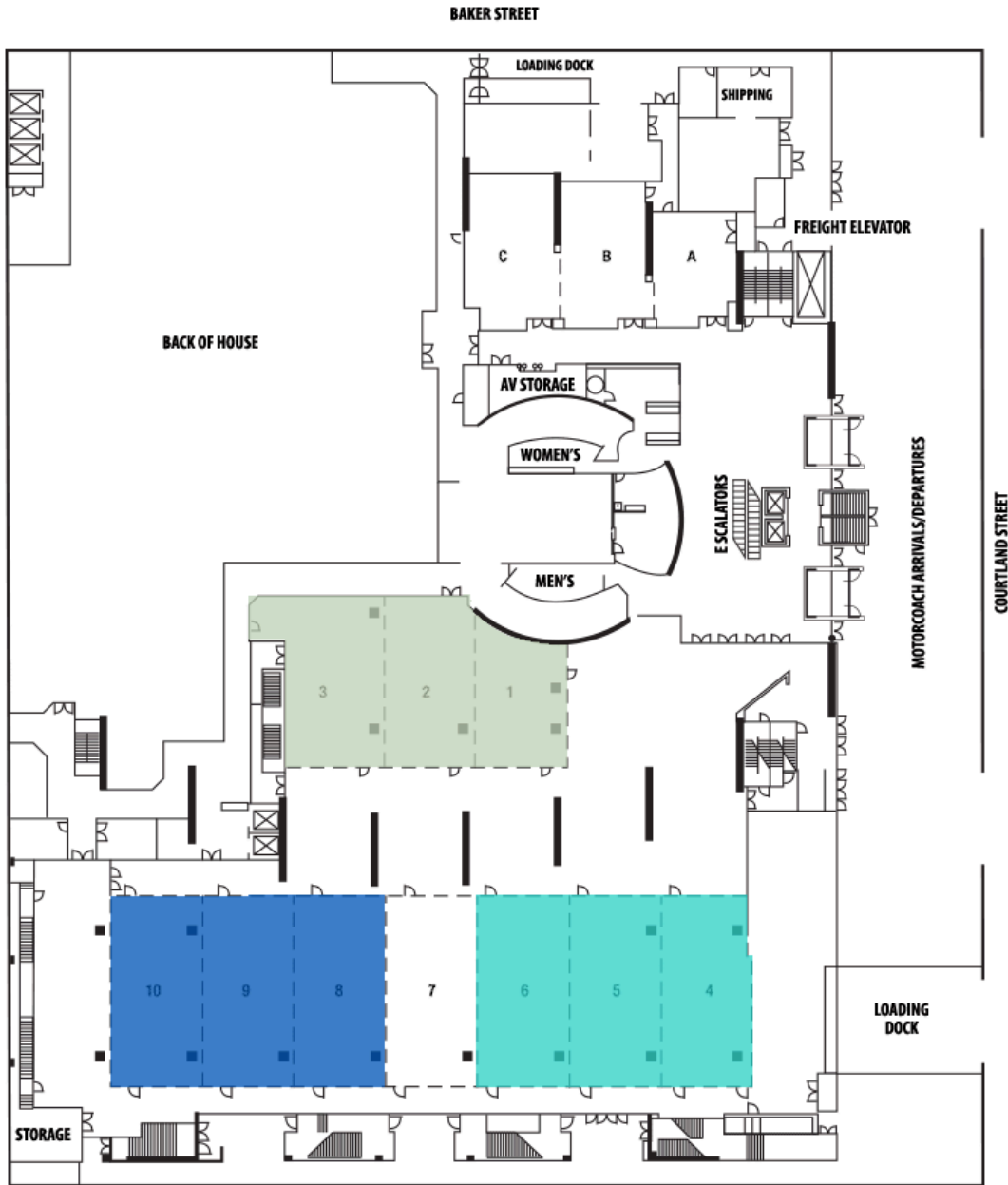

Activity Detail

Final Day Sample Meeting - Aug 7, 2017

Meeting Room	Capacity						
	Dimensions (LxWxH)	Square Feet	Theatre	Schoolroom	Hollow Square	Reception	Banquet
International 1	27.6x36.1x10	992	90	40	20	75	40
International 2	27.6x44.1x10	1,235	110	60	30	100	60
International 3	27.6x50.1x10	1,400	130	70	34	150	80
International 4	26.0x56.1x10	1,480	160	90	48	200	100
International 5	27.6x56.1x10	1,571	180	110	54	200	100
International 6	27.6x56.1x10	1,571	180	110	54	200	100
International 7	27.6x56.1x10	1,571	180	110	54	200	100
International 8	27.6x56.1x10	1,571	180	110	54	200	100
International 9	27.6x56.1x10	1,571	180	110	54	200	100
International 10	27.6x56.1x10	1,571	180	110	54	200	100
International A	34.1x24.1x10	870	80	36	18	50	40
International B	27.6x44.1x10	1,217	100	50	28	80	60
International C	29.6x46.6x10	1,372	120	60	30	100	80
International Hall*	—	28,281	1,860	522	—	4,600	2,200
International Ballroom 4-10	191.6x56.1x10	10,749	990	400	—	1,600	650
International 1-10 Pre-function	—	8,691	—	—	—	1,100	191

*Can display 142 - 8x10 booths or 115 - 10x10 booths